



Consult Heyco for Colors Other Than Black or White

# Heyco® Dome Plugs

- Closes unneeded panel holes.
- Convex, matte finish head tapers to thin edge (Except DP-187).
- Twenty-nine sizes for use in 3/16" (4,7mm) to 6" (152,4mm) diameter holes.
- Locks firmly into panel up to 1/4" (6,4mm) thick.
- Quick and easy installation.

### LabKit No. 3 (Part #2997)

Perfect for product design departments, experimental labs, and for all prototype work. LabKit contains an assortment of the most popular sizes of hole, vent, and pry out plugs. Pertinent information on each size is attached inside the box lid.

See page 3-33 for more details.

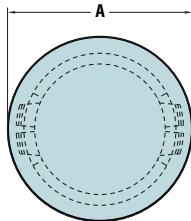

PANEL DIMENSIONS				PART NO.		DESCRIPTION	PART DIMENSIONS			
Maximum Thickness		Mounting Hole Diameter		Black	White		A Head Diameter		B Overall Height	
in.	mm.	in.	mm.			in.	mm.	in.	mm.	
.062	1,6	.187	4,7	*2590	*2591	** DP-187	.250	6,4	.234	5,9
.062	1,6	.250	6,3	2603	2604	** DP-250	.312	7,9	.312	7,9
.062	1,6	.312	7,9	2613	2614	** DP-312	.375	9,5	.312	7,9
.125	3,2	.375	9,5	2617	2618	DP-375	.468	11,9	.406	10,3
.125	3,2	.437	11,1	2633	2634	DP-437	.531	13,5	.406	10,3
.125	3,2	.500	12,7	2643	2644	DP-500	.578	14,7	.406	10,3
.125	3,2	.562	14,3	2653	2654	DP-562	.656	16,7	.406	10,3
.125	3,2	.625	15,9	2663	2664	DP-625	.718	18,2	.406	10,3
.125	3,2	.687	17,4	2673	2674	DP-687	.781	19,8	.406	10,3
.125	3,2	.750	19,1	2683	2684	DP-750	.921	23,4	.406	10,3
.125	3,2	.812	20,6	2693	2694	DP-812	.890	22,6	.406	10,3
.125	3,2	.875	22,2	2703	2704	DP-875	1.015	25,8	.453	11,5
.125	3,2	1.000	25,4	2713	2714	DP-1000	1.203	30,6	.453	11,5
.125	3,2	1.093	27,8							
		1.125	28,6	2723	2724	DP-1093	1.218	30,9	.453	11,5
.125	3,2	1.187	30,1	2733	2734	DP-1187	1.312	33,3	.453	11,5
.125	3,2	1.250	31,7	2740	2741	DP-1250	1.375	34,9	.453	11,5
.125	3,2	1.375	34,9	2753	2754	DP-1375	1.500	38,1	.453	11,5
.125	3,2	1.500	38,1	2763	2764	DP-1500	1.671	42,4	.453	11,5
.125	3,2	1.750	44,5	2773	2774	DP-1750	1.906	48,4	.453	11,5
.125	3,2	2.000	50,8	2783	2784	DP-2000	2.170	55,1	.469	11,9
.250	6,4	2.093-	53,2							
		2.125	54,0	2403	2404	DP-2.093	2.343	59,9	.760	19,3
.250	6,4	2.250	57,2	2411	2412	DP-2.25	2.479	63,0	.750	19,1
.250	6,4	2.500	63,5	2790	2791	DP-2.5	2.718	69,0	.750	19,1
.250	6,4	3.000	76,2	2455	2456	DP-3.0	3.171	80,5	.750	19,1
.250	6,4	3.375	85,7	2482	2483	DP-3.375	3.656	92,9	.750	19,1
.250	6,4	3.500	88,9	2464	2465	DP-3.5	3.656	92,9	.750	19,1
.250	6,4	4.000	101,6	2473	2474	DP-4.0	4.156	105,6	.750	19,1
.250	6,4	5.000	127,0	2451	2452	DP-5.0	5.219	132,5	.781	19,8
.250	6,4	6.000	152,4	2453	2454	DP-6.0	6.219	157,9	.781	19,8

Standard Colors: Black or White. Consult factory for color matching, prices, and minimum order quantities. Locking fingers in fractional increments up to the maximum panel thickness.

\*Convex, glossy finish head tapers to thin edge.

Approximate Head Thickness: .063" (1,6mm). Thickness may vary.

\*\*Depicts single panel thickness.

Quick Specs

Material	6/6 "Nylon"
Certifications	Recognized under the Component Program of Underwriters' Laboratories File #E-15331 Certified by the Canadian Standards Association File #LR-8919
Flammability Rating	94V-2
Material Temperature Index	125°C—Maximum temperature on part not to exceed 105°C