



# Heyco® Window Plugs

- Molded of transparent polycarbonate for internal viewing or light transmission.
- Sixteen sizes for use in 3/16" (4,7mm) to 2" (50,8mm) diameter holes.
- Locks firmly into panel up to 1/8" (3,2mm) thick.
- Snaps into mounting holes with fingertip pressure—no tools required.
- Flammability Rating 94V-2.
- Available in a variety of tints besides clear—consult factory.

PANEL DIMENSIONS				PART NO.	DESCRIPTION	PART DIMENSIONS			
Maximum Thickness		Mounting Hole Diameter				A Head Diameter		B Overall Height	
in.	mm.	in.	mm.			in.	mm.	in.	mm.
.062	1,6	.187	4,7	* 1300	WP-187	.250	6,4	.234	5,9
.062	1,6	.250	6,4	* 1301	WP-250	.312	7,9	.312	7,9
.062	1,6	.312	7,9	* 1302	WP-312	.375	9,5	.312	7,9
.125	3,2	.375	9,5	1303	WP-375	.468	11,9	.406	10,3
.125	3,2	.437	11,1	1304	WP-437	.531	13,5	.406	10,3
.125	3,2	.500	12,7	1305	WP-500	.563	14,3	.406	10,3
.125	3,2	.625	15,9	1307	WP-625	.734	18,6	.406	10,3
.125	3,2	.750	19,1	1309	WP-750	.859	21,8	.406	10,3
.125	3,2	.875	22,2	1311	WP-875	.953	24,2	.453	11,5
.125	3,2	1.000	25,4	1312	WP-1000	1.125	28,6	.453	11,5
.125	3,2	1.093-1.125	27,8-28,6	1313	WP-1093	1.218	30,9	.453	11,5
.125	3,2	1.187	30,1	1315	WP-1187	1.312	33,3	.453	11,5
.125	3,2	1.375	34,9	1314	WP-1375	1.468	37,2	.453	11,5
.125	3,2	1.500	38,1	1316	WP-1500	1.609	40,8	.453	11,5
.125	3,2	1.750	44,4	1318	WP-1750	1.875	47,6	.453	11,5
.125	3,2	2.000	50,8	1319	WP-2000	2.157	54,8	.453	11,5

Consult Heyco for Window Tints Other Than Clear.

Locking fingers in fractional increments up to the maximum panel thickness.  
\*Depicts single panel design.

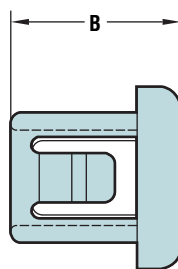

SINGLE PANEL THICKNESS DESIGN\*

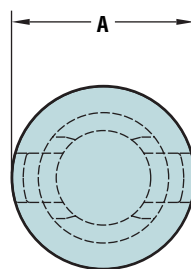

MULTIPLE PANEL THICKNESS DESIGN

Quick Specs

Material	Polycarbonate
Flammability Rating	94V-2
Material Temperature Index	135°C—Maximum temperature on part not to exceed 115°C