



Flexicon Conduit/Tubing Mounting Clips

With Integral Closure



FITS CONDUIT TRADE	PART NO.		DESCRIPTION	PART DIMENSIONS							
	Black	Gray		A Mounting Hole		B Max Width		C Max O.A Height		D Max.O.A. Thickness	
				in.	mm.	in.	mm.	in.	mm.	in.	mm.
10 mm	F8900	F8901	FCL 10	.197	5,0	.894	22,7	1.093	26,4	.787	20,0
13 mm	F8902	F8903	FCL 13	.197	5,0	.894	22,7	1.093	26,4	.787	20,0
16 mm	F8904	F8905	FCL 16	.205	5,2	1.039	26,4	1.173	29,8	.787	20,0
21 mm	F8906	F8907	FCL 21	.244	6,2	1.252	31,8	1.437	36,5	.787	20,0
28 mm	F8908	F8909	FCL 28	.244	6,2	1.606	40,8	1.752	44,5	.787	20,0
34 mm	F8910	F8911	FCL 34	.244	6,2	1.890	48,0	2.028	51,5	.787	20,0
42 mm	F8912	F8913	FCL 42	.244	6,2	2.252	57,2	2.370	60,2	.787	20,0
54 mm	F8914	F8915	FCL 54	.244	6,2	2.744	69,7	2.862	72,7	.787	20,0

Standard Colors: Black or Gray—Consult factory for other colors.

- For use with 10 mm thru 54 mm Flexicon corrugated conduit/tubing, see pages 0-1 and 0-2.
- Suitable for use with both fine and/or coarse pitch conduit/tubing.
- For mounting Flexicon corrugated conduit or tubing securely into place, vertically or horizontally.
- Only fingertip pressure is required to snap conduit or tubing into bracket.
- Suitable for use by original equipment manufacturers.
- Low profile design for space savings and pleasing appearance.
- Recommended distance between brackets at intervals not greater than 3 feet (914 mm) as required by Article 351-27 of 1996 NEC.
- Use one standard #10 (4-5M) screw for attaching bracket to panel or chassis (screw not included).
- Resists salt water, weak acids, gasoline, alcohol, oil, grease, and common solvents. This feature is not assessed by UL certification or testing.
- Can be easily opened for temporary access/removal and closed again to secure conduit.

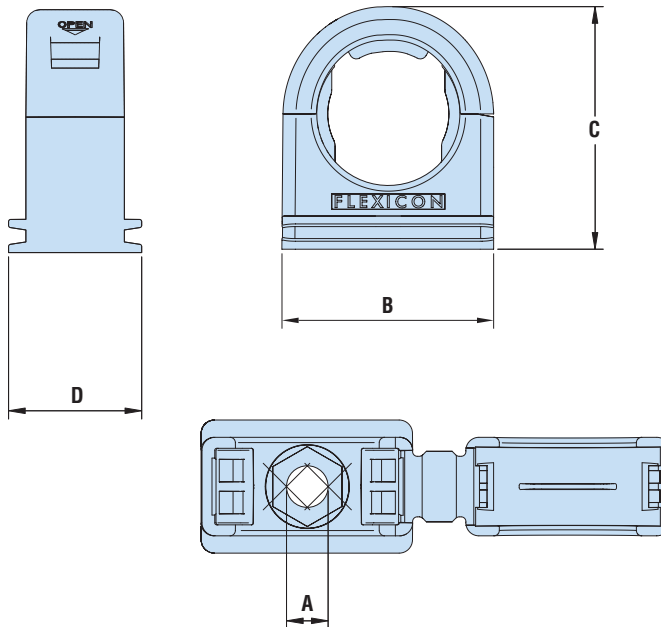

Material	Polyamide "Nylon" 6/6-(PA66)
Certifications	CE Approved as per BS EN50086
Flammability Rating	94 V2 and is Low Fire Hazard Including Low Smoke, Low Toxicity as well as Halogen, Sulphur, and Phosphorous Free
Temp. Rating	The temperature rating for all FPA fittings meets or exceeds that for all Flexicon conduit/tubing

Quick Specs