



RDD Round Wire Lockit™

The next generation in Strain Relief

US Patent No. 4,913,385

- Installs with fingertip pressure into an easily punched standard round or Double "D" strain relief hole. (No clumsy hand tools required!)
- Automated application equipment speeds assembly and lowers costs while reducing or eliminating repetitive manual assembly motions.
- Can be preassembled onto wire since chassis insertion isn't required to keep it LOCKED on the wire.
- Multiple panel locking steps snug lockit strain relief into range of panel thicknesses up to .157".
- Recognized (far exceeds UL's 35# pull-out test).
- 94V-2 flammability rating.
- Black, white, and custom colors available.
- Consult Heyco for other wire types and sizes.
- See page 2-4 for Heyco automated assembly equipment.
- See page 2-21 for matching plugs which can be used to fill/blank unused mounting holes.
- See page 2-8 for Designer's Lockit LabKit.

WILL FIT THESE CABLES				PANEL DIMENSIONS				PART NO.		DESCRIPTION
UL Type Designation	AWG Conductors	Approximate Size		Mounting Hole Size		Thickness		Black	White	
		in.	mm.	in.	mm.	in.	mm.			
AWM SJTO & SJ	18/2	.130	3,3	.625 w/	15,9 w/	.032	0,8	1870	1871	RDD 101-A
		.210	5,3	.550 flats	14,0 flats	.040	1,1			
						.048	1,2			
						.063	1,6			
						.099	2,5			
SV & SVT	18/3	.220	5,6	.625 w/	15,9 w/	.032	0,8	1852	1853	RDD 101
		.290	7,4	.550 flats	14,0 flats	.040	1,1			
						.048	1,2			
SJTO SEOW	18/2	.290	7,4	.875 w/	22,2 w/	.078	2,0	1855	1856	RDD 201-2
		.385	9,8	.770 flats	19,6 flats	.140	3,4			
SJTO & SEOW	18/3	.290	7,4	.875 w/	22,2 w/	.032	0,8	1857	1858	RDD 201
		.385	9,8	.770 flats	19,6 flats	.063	1,6			
						.099	2,5			
						.126	3,2			
				.157	4,0					

RDD 101-A

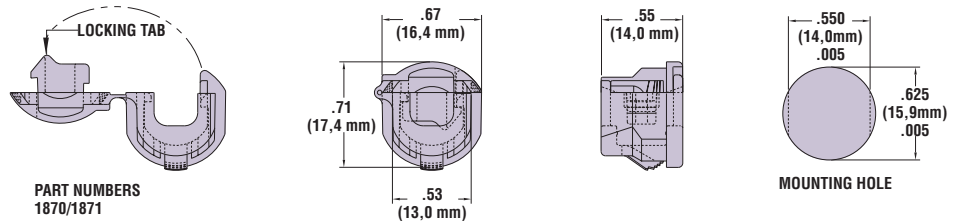

RDD 101

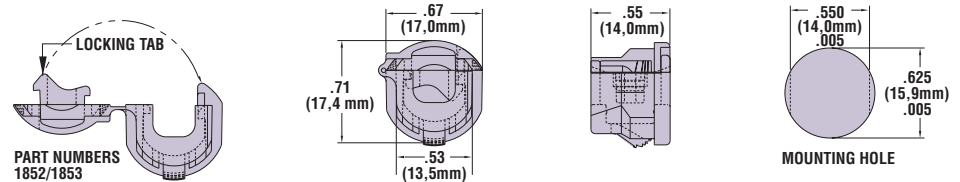

RDD 201-2, RDD 201

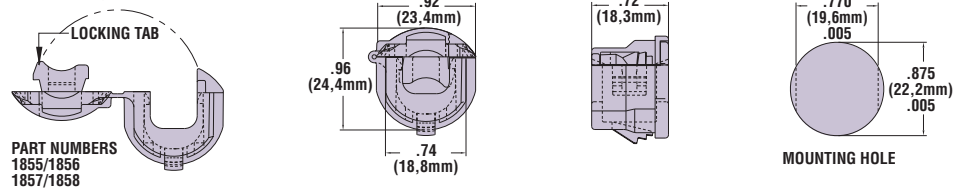

Quick Specs

Material	6/6 "Nylon"
Certifications	Recognized under the Component Program of Underwriters' Laboratories File #E-15331
	Certified by the Canadian Standards Association File #LR-8919
Flammability Rating	94V-2
Material Temperature Index	125°C—Maximum temperature on part not to exceed 105°C