



RDD Flat Wire Lockit™

The next generation in Strain Relief

US Patent No. 4,913,385

- Installs with fingertip pressure into an easily punched standard round or Double "D" strain relief hole. (No clumsy hand tools required!)
- Automated application equipment speeds assembly and lowers costs while reducing or eliminating repetitive manual assembly motions.
- Can be preassembled onto wire since chassis insertion isn't required to keep it LOCKED on the wire.
- Multiple panel locking steps snug lockit strain relief into range of panel thicknesses up to .157".
- **UL** Recognized (far exceeds UL's 35# pull-out test).
- 94V-2 flammability rating.
- Black, white, and custom colors available.
- Consult Heyco for other wire types and sizes.
- See page 2-4 for Heyco automated assembly equipment.
- See page 2-21 for matching plugs which can be used to fill/blank unused mounting holes.
- See page 2-8 for Designer's Lockit Labkit.

WILL FIT THESE CABLES				CHASSIS DIMENSIONS				PART NO.		DESCRIPTION
UL Type Designation	AWG Conductors	Approximate Size		Mounting Hole Size		Thickness		Black	White	
		in.	mm.	in.	mm.	in.	mm.			
SPT-1	18/2	.12 x .22	2,5 x 7,8	.625 w/ .550 flats	15,9 w/ 14,0 flats	.032	0,8	1872	1873	RDD 100A
		.12 x .32	3,0 x 7,8			.040	1,1			
	18/3	.12 x .32	3,0 x 7,8			.048	1,2			
		.12 x .32	3,0 x 7,8			.063	1,6			
		.12 x .32	3,0 x 7,8			.099	2,5			
SPT-2 HPN	18/2	.12 x .32	3,0 x 7,8	.625 w/ .550 flats	15,9 w/ 14,0 flats	.032	0,8	1874	1875	RDD 100
		.16 x .32	4,1 x 7,8			.040	1,1			
HPN	16/3	.16 x .37	4,1 x 9,4	.625 w/ .550 flats	15,9 w/ 14,0 flats	.048	1,2	1874	1875	RDD 100
		.16 x .37	4,1 x 9,4			.063	1,6			
SPT-2	18/3	.15 x .40	3,8 x 10,2	.875 w/ .770 flats	22,2 w/ 19,6 flats	.032	0,8	1878	1879	RDD 200
		.16 x .41	4,1 x 10,4			.063	1,6			
SPT-3	18/2	.19 x .35	4,8 x 8,9	.875 w/ .770 flats	22,2 w/ 19,6 flats	.099	2,5	1878	1879	RDD 200
		.19 x .39	4,8 x 9,9			.126	3,2			
	16/2	.20 x .37	5,1 x 9,4			.157	4,0			
		.20 x .37	5,1 x 9,4							
HPN	16/3	.16 x .37	4,1 x 9,4	.875 w/ .770 flats	22,2 w/ 19,6 flats	.078	2,0	1876	1877	RDD 200-2
		.16 x .37	4,1 x 9,4			.140	3,4			
SPT-2	18/3	.15 x .40	3,8 x 10,2	.875 w/ .770 flats	22,2 w/ 19,6 flats	.078	2,0	1876	1877	RDD 200-2
		.16 x .41	4,1 x 10,4			.140	3,4			
SPT-3	18/2	.19 x .35	4,8 x 8,9	.875 w/ .770 flats	22,2 w/ 19,6 flats	.078	2,0	1876	1877	RDD 200-2
		.19 x .39	4,8 x 9,9			.140	3,4			
	16/3	.20 x .43	5,1 x 10,9							
		.20 x .43	5,1 x 10,9							
14/2	.24 x .42	.24 x .42	6,1 x 10,7							

RDD 100 & RDD 100-A
RDD 200 & RDD 200-2

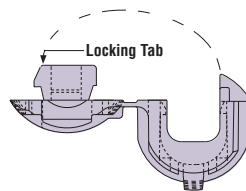

PART NUMBERS
1878/1879
1876/1877

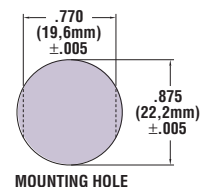
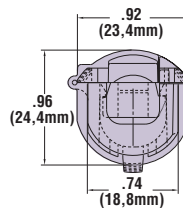

Quick Specs

Material	6/6 "Nylon"
Certifications	UL Recognized under the Component Program of Underwriters' Laboratories File #E-15331
	SP Certified by the Canadian Standards Association File #LR-8919
Flammability Rating	94V-2
Material Temperature Index	125°C—Maximum temperature on part not to exceed 105°C