

Tinnerman® Multiple Thread Engaging Nut and Bolt Retainers

The dimensions of the above parts are envelope dimensions only. For complete design information, please request a blueprint from your Tinnerman representative or the Tinnerman Engineering department.

Metric parts listed in italic

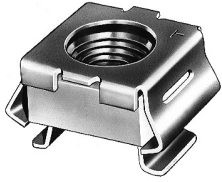

Nut Retainers

Tinnerman **Nut Retainers** combine the best advantages of spring steel fasteners with the high strength of a multi-threaded nut. They snap readily into bolt-receiving position at panel edges or center-panel locations and retain themselves in place.

Their application does not require special tools or skills, eliminating the need for special operations. They can be applied at any convenient spot along the assembly line after painting or porcelainizing, thus eliminating the need for masking or retapping clogged threads. The nut floats within the spring steel cage more than enough to offset normal hole misalignment. No other line of heavy duty fasteners offers so many advantages for blind location assembly.

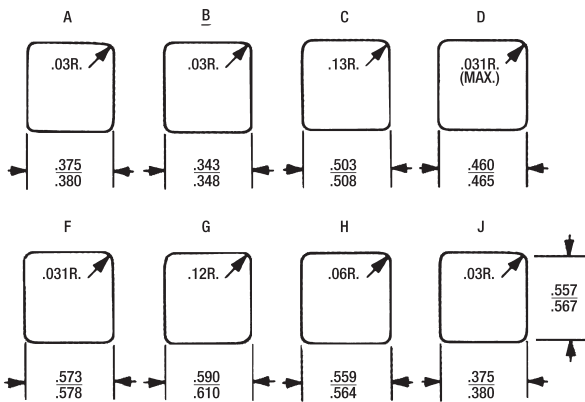
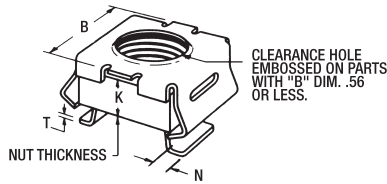
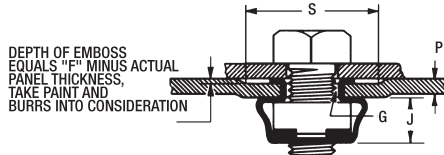

Screw Size	P Panel Range	F	S Emboss Sq. (min.)	G Mnt. Hole	B	J	N	K	T	Mat'l. Part Thick. Number
6-32	.025-.063	.097	.421	.281 sq.	.450	.190	.060	.124	.017	D30395-632
	.064-.105	.140	.531	A or B	.520	.250	.060	.156	.020	D7941-632
	.093-.126	.160	.531	A or B	.520	.250	.060	.156	.020	D7951-632
MAX.7	<i>.635-1.600</i>	<i>2.540</i>	<i>13.487</i>	<i>A or B</i>	<i>13.208</i>	<i>6.350</i>	<i>1.524</i>	<i>3.962</i>	<i>.508</i>	<i>D7931-M407</i>
	<i>1.626-2.667</i>	<i>3.556</i>	<i>13.487</i>	<i>A or B</i>	<i>13.208</i>	<i>6.350</i>	<i>1.524</i>	<i>3.962</i>	<i>.508</i>	<i>D7941-M407</i>
8-32	.025-.063	.100	.531	A or B	.520	.250	.060	.156	.020	D7931-832
	.064-.105	.140	.531	A or B	.520	.250	.060	.156	.020	D7941-832
	.093-.126	.160	.531	A or B	.520	.250	.060	.156	.020	D7951-832
	.125-.156	.190	.531	A or B	.520	.250	.060	.187	.020	D31365-832
10-24	.025-.063	.100	.531	A or B	.520	.250	.060	.156	.020	D7931-1024
	.064-.105	.140	.531	A or B	.520	.250	.060	.156	.020	D7941-1024
	.093-.126	.175	.734	C or D	.660	.300	.100	.218	.025	D7957-1024
	.125-.156	.190	.531	A or B	.520	.250	.060	.187	.020	D31365-1024
10-32	.025-.063	.100	.531	A or B	.520	.250	.060	.156	.020	D7931-1032
	.064-.105	.140	.531	A or B	.520	.250	.060	.156	.020	D98579-1032*
	.093-.126	.190	.531	A or B	.520	.250	.060	.156	.020	D7951-1032
M5X.8	<i>1.626-2.667</i>	<i>3.556</i>	<i>13.487</i>	<i>A or B</i>	<i>13.208</i>	<i>6.350</i>	<i>1.524</i>	<i>3.962</i>	<i>.508</i>	<i>D7941-M508</i>
12-24	.025-.063	.100	.531	A or B	.520	.250	.060	.156	.020	D7931-1224
M6X1	<i>.635-1.600</i>	<i>2.540</i>	<i>13.487</i>	<i>A or B</i>	<i>13.208</i>	<i>6.350</i>	<i>1.524</i>	<i>4.750</i>	<i>.508</i>	<i>D7988-M61</i>
	<i>1.620-2.670</i>	<i>3.560</i>	<i>13.490</i>	<i>A or B</i>	<i>13.210</i>	<i>6.350</i>	<i>1.520</i>	<i>4.720</i>	<i>.510</i>	<i>D98580-M61*</i>
1/4-20	.025-.063	.100	.531	A or B	.520	.250	.060	.187	.020	D7988-1420
	.064-.105	.140	.531	A or B	.520	.250	.060	.186	.020	D98580-1420*
	.093-.126	.160	.531	A or B	.520	.250	.060	.187	.020	D7956-1420
	.125-.156	.190	.531	A or B	.520	.250	.060	.186	.020	D98581-1420*
5/16-18	.028-.056	.095	.734	C or D	.660	.300	.100	.218	.025	D7937-5618
	.093-.126	.175	.734	C or D	.660	.300	.100	.218	.025	D7957-5618
	.127-.162	.205	.734	C or D	.660	.300	.100	.218	.025	D7935-5618
5/16-24	.093-.126	.175	.734	C or D	.660	.300	.100	.218	.025	D7957-5624
M8X1.25	<i>2.362-3.200</i>	<i>4.445</i>	<i>18.644</i>	<i>C or D</i>	<i>16.764</i>	<i>7.620</i>	<i>2.540</i>	<i>5.537</i>	<i>.635</i>	<i>D7957-M8125</i>
	<i>4.496-5.004</i>	<i>6.223</i>	<i>18.644</i>	<i>C or D</i>	<i>16.764</i>	<i>7.620</i>	<i>2.540</i>	<i>5.537</i>	<i>.635</i>	<i>D31910-M8125</i>
3/8-16	.028-.056	.095	.734	C or D	.660	.300	.100	.218	.025	D7937-3816
	.093-.126	.165	.828	E or H	.870	.410	.100	.304	.025	D7969-3816
	.162-.210	.245	.828	G or F	.870	.410	.100	.304	.025	D30683-3816
	.240-.260	.305	.812	E or F	.870	.410	.100	.304	.025	D30096-3816
3/8-24	.240-.260	.305	.812	E or F	.870	.410	.100	.304	.025	D30096-3824
M10X1.5	<i>3.226-4.115</i>	<i>5.207</i>	<i>18.644</i>	<i>C or D</i>	<i>16.764</i>	<i>7.620</i>	<i>2.540</i>	<i>5.537</i>	<i>.635</i>	<i>D7935-M1015</i>
7/16-14	.093-.126	.165	.828	E or F	.870	.410	.100	.304	.025	D7969-7614
	.162-.210	.245	.828	G or F	.870	.410	.100	.304	.025	D30683-7614
1/2-13	.059-.092	.135	.828	E or F	.870	.410	.110	.304	.025	D7968-1213
	.127-.162	.205	.828	E or F	.870	.410	.100	.304	.025	D7925-1213
	.240-.260	.305	.812	E or F	.870	.410	.100	.304	.025	D30096-1213

* Stainless Steel Parts