

U-Type Fasteners

Material: All parts are **Spring Steel**, heat treated, unless otherwise specified.
 The only variations available are those shown with suffix letters in the part number.
 SS – Stainless Steel BE – Beryllium Copper P – Phosphor Bronze

U-Type Speed Nuts perform the same fastening functions as the J-Type, but are used where a full bearing surface on the lower leg is desired. They are self-retained in screw-receiving position to provide simple, rapid attachment of mating panels and cannot turn as the screw is driven.

Corrosion presents no problem, as the **Speed Nut** will not freeze on screw threads. In fact, the **Speed Nut** impression actually cleans out rust, dirt or paint clots from the screw threads as they are removed.

How to apply U-Type Fasteners

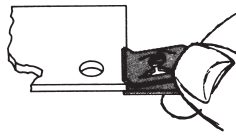

Start Tinnerman **U-Type Speed Nut** over the edge of panel.

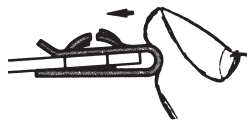

Push into position until extrusion on lower leg snaps into screw hole. The **Speed Nut** "floats" in screw-receiving position to correct for normal misalignment in panel mounting holes.

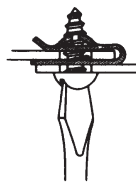

Place second panel in position and drive the screw. Access to opposite side is unnecessary. Flush mounting can be made by embossing either panel.

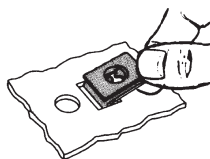

U-Type Speed Nut can be installed in center of panel through a rectangular hole, permitting front-mounting attachments.

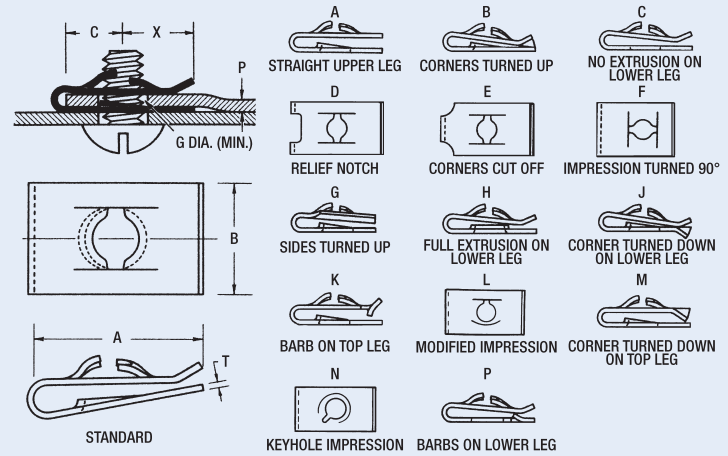

Screw Size	P Panel Range	Design Variation	A Lgth.	B Width	C Max. Ctr. Hole to Edge	X Ctr. Hole to End	G Panel Hole Dia.	T Mat'l. Thick.	Part Number
4-40	.062-.094	C	.390	.252	.156	.210	.125	.012	C991-440
6-32	.185-.195	Std.	.590	.312	.263	.317	.218	.017	C71117-632
6A or 6B	.067-.083	F	.465	.500	.203	.210	.187	.025	C71020-6
MAX1.6	1.550-3.000	N	15.750	11.000	6.500	7.870	5.300	.640	C71677-M416
8-32	.099-.104	CDFK	.700	.630	.388	.240	.187	.017	C11459SS-832
8A or 8B	.070-.090	ABDF	.512	.500	.296	.190	.218	.028	C71281-8
10-24	.051-.081	Std.	.630	.440	.281	.320	.281	.020	C596-1024
10A	.065-.087	D	.640	.440	.265	.330	.250	.031	C9240-10A
10A or 10B	.045-.062	E	.950	.500	.562	.350	.250	.031	C8125-10
M5X1.59	2.000-3.000	CDKN	14.350	8.000	6.000	6.500	7.000	.710	C71680-M5159
12-24	.135-.145	EF	.610	.630	.281	.260	.312	.022	C19762-1224
M6X1	1.630-3.180	Std.	24.640	12.700	12.700	10.920	8.710	.640	C1303-M61
1/4-20	.051-.109	H	.790	.500	.312	.390	.343	.025	C14969-1420
14A	.028-.056	E	.930	.560	.421	.430	.312	.037	C8126-14A
14B	.115-.125	C	.970	.500	.500	.420	.281	.037	D11482-14Z
5/16-18	.112-.140	Std.	1.035	.630	.562	.395	.375	.028	C17234-5618

