



Heyco® Thick Panel Rubber Grommets

For Panels .250" (6,4 mm) to .375" (9,5 mm) Thick

MOUNTING HOLE DIAMETER		PART NO.	DESCRIPTION	MATERIAL	PART DIMENSIONS					
in.	mm.				A Inside Diameter		B Head Diameter		C Overall Height	
		Black			in.	mm.	in.	mm.	in.	mm.
For .250" (6,4 mm) Thick Panels										
.312	7,9	G1023	RG 312-6-8	SBR	.19	4,8	.44	11,1	.38	9,5
.437	11,1	G1058	RG 437-8-8	Nitrile	.25	6,4	.63	15,9		
.500	12,7	G1086	RG 500-10-8	Nitrile	.31	8,0	.63	15,9	.63	15,9
		G1095	RG 500-12-8	SBR	.38	9,5	.75	19,1		
.562	14,3	G1117	RG 562-10-8	Nitrile	.31	8,0	.81	20,6	.50	12,7
.625	15,9	G1134	RG 625-12-8	SBR	.38	9,5	.88	22,2		
.687	17,5	G1154	RG 687-14-8	SBR	.44	11,1	.94	23,8		
.812	20,6	G1195	RG 812-16-8	SBR	.50	12,7	1.06	27,0		
.875	22,2	G1200	RG 812-18-8	SBR	.56	14,3	1.06	27,0	.56	14,3
		G1220	RG 875-20-8	SBR	.63	15,9	1.13	28,6		
1.000	25,4	G1257	RG 1000-22-8	SBR	.69	17,5	1.31	33,3	.63	15,9
		G1264	RG 1000-28-8	SBR	.88	22,2	1.25	31,8		
1.062	27,0	G1273	RG 1062-24-8	SBR	.75	19,1	1.38	34,9	.56	14,3
1.125	28,6	G1279*	RG 1125-26-8	SBR	.80	20,4	1.38	34,9	.51	12,9
1.250	31,8	G1301	RG 1250-24-8	SBR	.75	19,1	1.63	41,3	.44	11,1
		G1307	RG 1250-28-8	SBR	.88	22,2	1.63	41,3		
1.375	34,9	G1324	RG 1375-32-8	SBR	1.00	25,4	1.75	44,5	.63	15,9
1.500	38,1	G1353	RG 1500-40-8	SBR	1.25	31,8	1.75	44,5	.50	12,7
		G1354	RG 1500-40-8A	SBR	1.25	31,8	2.00	50,8		
1.750	44,5	G1373	RG 1750-48-8	SBR	1.50	38,1	2.00	50,8	.50	12,7
		G1374	RG 1750-48-8A	SBR	1.50	38,1	2.13	54,0		
2.000	50,8	G1393	RG 2000-56-8	SBR	1.75	44,5	2.50	63,5	.53	13,5
		G1394	RG 2000-56-8A	Nitrile	1.75	44,5	2.50	63,5		
2.500	63,5	G1421	RG 2.5-64-8	SBR	2.00	50,8	3.00	76,2	.56	14,3
		G1425	RG 2.5-72-8	SBR	2.25	57,2	3.00	76,2		

For .375" (9,5 mm) Thick Panels

.375	9,5	G1043	RG 375-10-12	SBR	.31	8,0	.56	14,3	.50	12,7
.500	12,7	G1096	RG 500-12-12	SBR	.38	9,5	.63	15,9	.63	15,9
.562	14,3	G1121	RG 562-12-12	SBR	.38	9,5	.75	19,1	.75	19,1
.625	15,9	G1136	RG 625-13-12	SBR	.41	10,3	.81	20,6	.63	15,9
.750	19,1	G1182	RG 750-16-12	SBR	.50	12,7	1.00	25,4		
.875	22,2	G1214	RG 875-18-12	SBR	.56	14,3	1.06	27,0		
.968	24,6	G1232	RG 968-22-12	SBR	.69	17,4	1.31	33,3		
1.000	25,4	G1249	RG 1000-18-12	SBR	.56	14,3	1.25	31,8	.75	19,1
1.125	28,6	G1278	RG 1125-24-12	SBR	.75	19,1	1.63	41,3		
1.250	31,8	G1308	RG 1250-28-12	Neoprene	.88	22,2	1.75	44,5	.75	19,1
		G1314	RG 1250-32-12	SBR	1.00	25,4	1.50	38,1		
1.375	34,9	G1326	RG 1375-32-12	SBR	1.00	25,4	1.75	44,5	.75	19,1
1.750	44,5	G1375	RG 1750-48-12	SBR	1.50	38,1	2.13	54,0		
2.000	50,8	G1395	RG 2000-56-12	SBR	1.75	44,5	2.50	63,5	.63	15,9
2.500	63,5	G1427	RG 2.5-72-12	SBR	2.25	57,2	3.00	76,2	.75	19,1

Standard color black. *G1279 Panel Thickness is .257" (6,5 mm)



- **Used to protect through holes.** Help eliminate sharp edges so your wires are protected and add aesthetic value to your application.
- 38 sizes available that accommodate mounting holes ranging from .312" (7,9 mm) to holes as large as 2.50" (63,5 mm) in diameter and panel thicknesses of .250" (6,4 mm) and .375" (9,5 mm).
- Rubber grommets are constructed of SBR (unless otherwise noted) with an operating temperature range of -40°F (-40°C) to 221°F (105°C).
- SBR grommets have good water resistant characteristics and are suitable for most moderate chemicals and wet or dry organic acids.
- Provide vibration dampening.

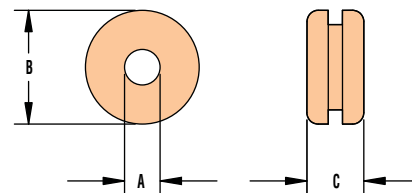

Material: SBR, Nitrile or Neoprene
 Temperature Range: -40°F (-40°C) to 221°F (105°C)

Quick Specs