

CROSS SECTION OF RIV-FLOAT®-SHORT Installed

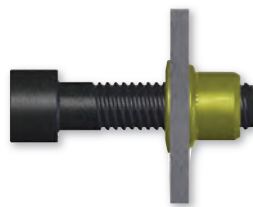

Standard Rivet Nut Installed



FEATURES AND BENEFITS

- Accounts for tolerance stack up in joint design and misalignment during service of the joint.
- New Low-Profile design provides greater backside clearance.
- Allows for installation post finish in applications where riveted nut plates or cage nuts are typically used.
- Mechanically locked RIV-FLOAT®-Short available with prevailing torque feature to IFI SPEC 100/107.
- 0.020" Radial Float.
- RoHS Compliant.

- The RIV-FLOAT® series provides easy, accurate, and fast attachment of components in off-center applications.

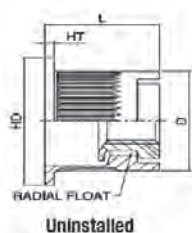

RFK INCH THREAD SMALL FLANGE SERIES (UNIT - INCHES)

SHEREX Part Number Inch - Steel	Thread Size	Radial Float	Grip Range		L	HD	HT	D	IL	Hole Size
			Min.	Max.						
RFSK2-0832-100	8-32 UNC	0.020	.020	.100	.394	.480	.025	.431	.246	.433
RFSK2-1024-100	10-24 UNC	0.020	.020	.100	.394	.480	.025	.431	.246	.433
RFSK2-1032-100	10-32 UNF	0.020	.020	.100	.394	.480	.025	.431	.246	.433

RFK METRIC THREAD SMALL FLANGE SERIES (UNIT - MILLIMETERS)

SHEREX Part Number Metric - Steel	Thread Size	Radial Float	Grip Range		L	HD	HT	D	IL	Hole Size
			Min.	Max.						
RFSK2-470-2.5	M4x0.7 ISO	0.50	0.50	2.50	10.00	12.20	.63	10.95	6.25	11.00
RFSK2-580-2.5	M5x0.8 ISO	0.50	0.50	2.50	10.00	12.20	.63	10.95	6.25	11.00

RFL INCH THREAD LARGE FLANGE SERIES (UNIT - INCHES)

SHEREX Part Number Inch - Steel	Thread Size	Radial Float	Grip Range		L	HD	HT	D	IL	Hole Size
			Min.	Max.						
RFLS2-0832-100	8-32 UNC	0.020	.020	.100	.406	.555	.033	.431	.246	.433
RFLS2-1024-100	10-24 UNC	0.020	.020	.100	.406	.555	.033	.431	.246	.433
RFLS2-1032-100	10-32 UNF	0.020	.020	.100	.406	.555	.033	.431	.246	.433

RFL METRIC THREAD SMALL FLANGE SERIES (UNIT - MILLIMETERS)

SHEREX Part Number Metric - Steel	Thread Size	Radial Float	Grip Range		L	HD	HT	D	IL	Hole Size
			Min.	Max.						
RFLS2-470-2.5	M4x0.7 ISO	0.50	0.50	2.50	10.30	14.10	.85	10.95	6.25	11.00
RFLS2-580-2.5	M5x0.8 ISO	0.50	0.50	2.50	10.30	14.10	.85	10.95	6.25	11.00

*RIV-FLOAT®-Short is patent pending

FLOATING TECHNOLOGIES

RIV-FLOAT®-SHORT vs. Riveted Nut Plates vs. Cage Nuts

RIVETED NUT PLATE

- Requires three holes to be drilled (1 for the plate & 2 for the rivets).
- Requires access to both sides of the work piece.
- 15-20 second installation time.

CAGE NUT

- Requires a square hole to be punched.
- Requires access to both sides of the work piece.
- 15-20 second installation time.

RIV-FLOAT®-SHORT

- Only 1 round hole needs to be drilled.
- Access from only one side of the work is necessary for installation.
- 2-3 second installation time.

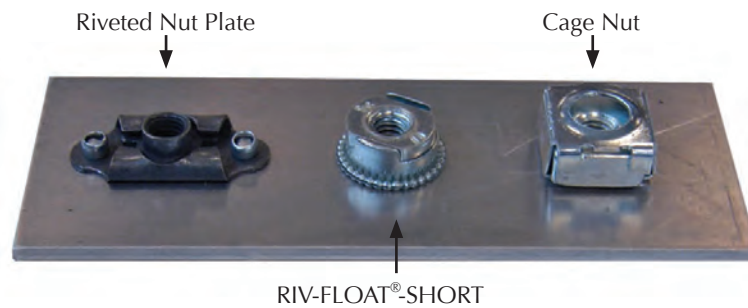

SINGLE KITS - RIV-FLOAT®-SHORT

- | | |
|--------------------|--|
| • RNHT-0832RFS BAG | 1 Installation Tool, 1 Mandrel, 15 Rivfloat Shorts |
| • RNHT-1032RFS BAG | 1 Installation Tool, 1 Mandrel, 15 Rivfloat Shorts |
| • RNHT-M4RFS BAG | 1 Installation Tool, 1 Mandrel, 15 Rivfloat Shorts |
| • RNHT-M5RFS BAG | 1 Installation Tool, 1 Mandrel, 15 Rivfloat Shorts |

MULTI KITS - RIV-FLOAT®-SHORT

- | | |
|----------------------|--|
| • RNHT RFS Inch Kit | 1 Installation Tool for 8-32, 1 Mandrel, 1 Installation Tool for 10-32, 1 Mandrel, 1 Installation Tool for 1/4-20, 1 Mandrel, (30) 6-32, (30) 8-32, (30) 10-32 and (20) 1/4-20 Rivfloat Shorts |
| • RNHT RF Metric Kit | 1 Installation Tool for M4, 1 Mandrel, 1 Installation Tool for M5, 1 Mandrel, 1 Installation Tool for M6, 1 Mandrel, (40) M4, (30) M5 and (20) M6 Rivfloat Shorts |



RIV-FLOAT®-SHORT is installed with a **FLEX-5** Hydro-Pneumatic Tool with a RIV-FLOAT®-SHORT Anvil

CENTERING
NOSEPIECE

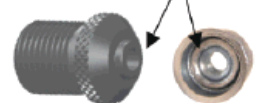

RIV-FLOAT®-Short is patent pending

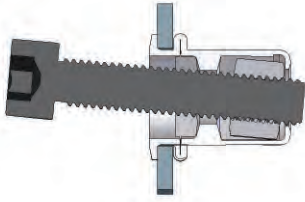

CROSS SECTION OF RIV-FLOAT® INSTALLED

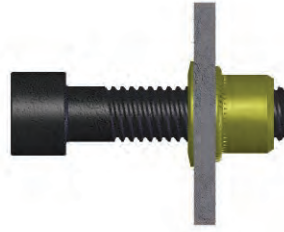

STANDARD RIVET NUT INSTALLED

FEATURES AND BENEFITS

- Accounts for tolerance stack up in joint design and misalignment during service of the joint.
- Floating nut aligns to drive angle of screw virtually eliminating cross threading and spin out.
- Allows for installation in post painted or powder coat applications where riveted nut plates or cage nuts are typically used
- RoHS compliant Zinc electroplate to 8µm with trivalent chromate - 96/240 hrs (WR/RR)
- Designed with higher thread strength than regular rivet nuts
- Mechanically locked RIV-FLOAT® is available with prevailing torque feature to IFI spec 100/107

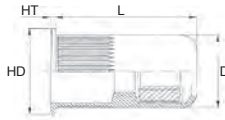

UNINSTALLED

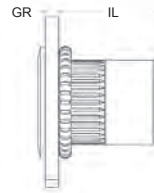

INSTALLED



- The RIV-FLOAT® series provides easy, accurate, and fast attachment of components in off-center applications.

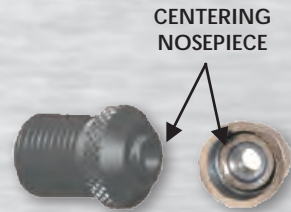

CENTERING NOSEPIECE

- The RIV-FLOAT® series should be installed with the FLEX-5 Hydro-Pneumatic Tool with a RIV-FLOAT® Anvil.

RFK INCH THREAD SMALL FLANGE SERIES (UNIT - INCHES)

Part Number Inch (Steel)	Thread Size	Radial Deflection	Grip Range		L ± .0215	HD ± .010	HT ± .002	D Max.	IL Ref.	Hole Size +.006/- .000
			Min.	Max.						
RFK2-0632-130	6-32 UNC	0.020	0.027	.130	.7195	.455	.022	.390	.522	.391
RFK2-0832-130	8-32 UNC	0.020	0.027	.130	.7195	.455	.022	.390	.522	.391
RFK2-1032-150	10-32 UNF	0.015	0.027	.150	.7195	.455	.022	.390	.522	.391
RFK2-2520-150	1/4-20 UNC	0.030	0.027	.150	.8190	.595	.022	.530	.630	.531

RFK METRIC THREAD SMALL FLANGE SERIES (UNIT - MILLIMETERS)

Part Number Metric (Steel)	Thread Size	Radial Deflection	Grip Range		L ± .55	HD ± .25	HT ± .05	D Max.	IL Ref.	Hole Size +.15/- .000
			Min.	Max.						
RFK2-470-3.3	M4x0.7 ISO	0.51	0.7	3.3	18.28	11.56	0.55	9.91	13.25	10.00
RFK2-580-3.8	M5x0.8 ISO	0.38	0.7	3.8	18.28	11.56	0.55	9.91	13.25	10.00
RFK2-610-3.8	M6x1.0 ISO	0.76	0.7	3.8	20.80	15.11	0.55	13.46	16.00	13.50

RFL INCH THREAD LARGE FLANGE SERIES (UNIT - INCHES)

Part Number Inch (Steel)	Thread Size	Radial Deflection	Grip Range		L ± .0215	HD ± .010	HT ± .003	D Max.	IL Ref.	Hole Size +.006/- .000
			Min.	Max.						
RFL2-0632-130	6-32 UNC	0.020	.027	.130	.7195	.500	.030	.390	.522	.391
RFL2-0832-130	8-32 UNC	0.020	.027	.130	.7195	.500	.030	.390	.522	.391
RFL2-1032-150	10-32 UNF	0.015	.027	.150	.7195	.500	.030	.390	.522	.391
RFL2-2520-150	1/4-20 UNC	0.030	.027	.150	.8190	.685	.035	.530	.630	.531

RFL METRIC THREAD LARGE FLANGE SERIES (UNIT - MILLIMETERS)

Part Number Metric (Steel)	Thread Size	Radial Deflection	Grip Range		L ± .55	HD ± .25	HT ± .08	D Max.	IL Ref.	Hole Size +.15/- .000
			Min.	Max.						
RFL2-470-3.3	M4x0.7 ISO	0.51	0.7	3.3	18.28	12.70	0.76	9.91	13.25	10.00
RFL2-580-3.8	M5x0.8 ISO	0.38	0.7	3.8	18.28	12.70	0.76	9.91	13.25	10.00
RFL2-610-3.8	M6x1.0 ISO	0.76	0.7	3.8	20.80	17.40	0.89	13.46	16.00	13.50

RIV-FLOAT® is covered under US Patent No. "7,713,011"

Toll Free: **800-606-4466** Fax: **714-375-4936**